

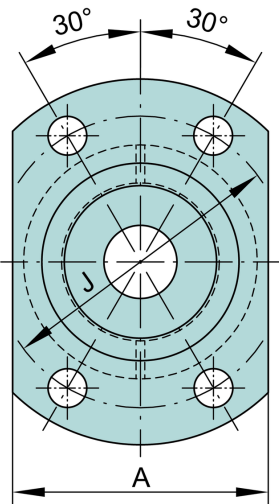

Width (B)	20 mm
Brand	INA



COMPONENT

Axial Angular Contact
Bearings



Pacific International Bearing, Inc.
33258 Central Ave, Union City, CA 94587
1-800-228-8895, 510-512-7000,
info@pibsales.com
www.pibsales.com

This file and any associated information and specifications are provided for reference and evaluation purposes only, and is subject to change without notice. PIB makes no representations, warranties or guarantees as to the appropriateness, accuracy, completeness, or suitability for any purpose, of the file, information or specifications. You are solely responsible for the use of the file, information or specifications.

ZKLFA1050-2RS
INA
10mm X 32mm X 20mm, Axial Angular
Contact, Ball Bearing, Double Direction,
Screw Mounting, Gap Seals

UNIT

Metric

SHEET